

# PRIVACY DOOR LATCH - PDL01-XX

www.hardwooddesignstudio.com

- .Simple to operate
- .ADA compliant
- .Enhanced in-room privacy
- .Cannot be used to keep door ajar
- .Small footprint
- .Easy to install

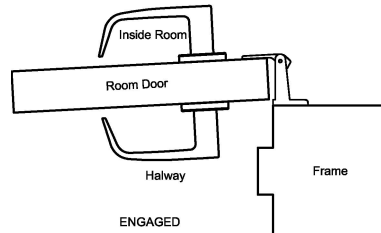
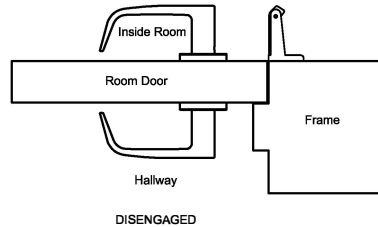
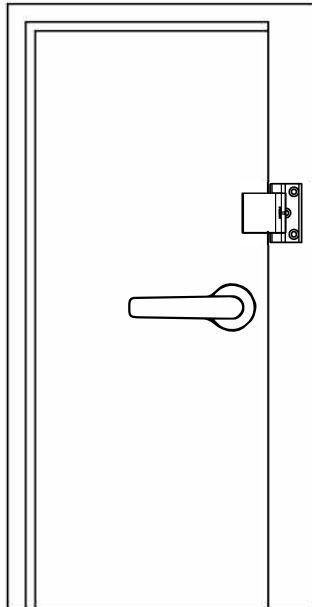
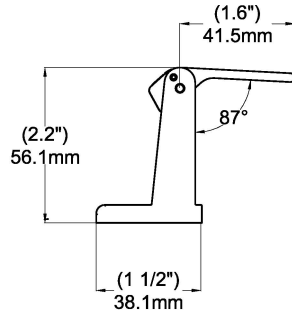

1. Determine mounting height
2. Apply the mounting template sticker to the frame at mounting height.
3. Center punch and drill 5/32 " pilot holes where indicated.
4. Mont the latch on the door frame (on top of the template) with the fasteners provided
5. Check product performance by extending the PDL latch after the door is closed
6. Close the door and push the PDL to the disengaged position. The door should open freely.